

---

*Comfort-Cire*®

**Century**®

---

PARTS LIST

**Inverter Multi Zone  
Outdoor Ductless Mini-Split**

A-VMH28TV-1

# EXPLODED VIEW

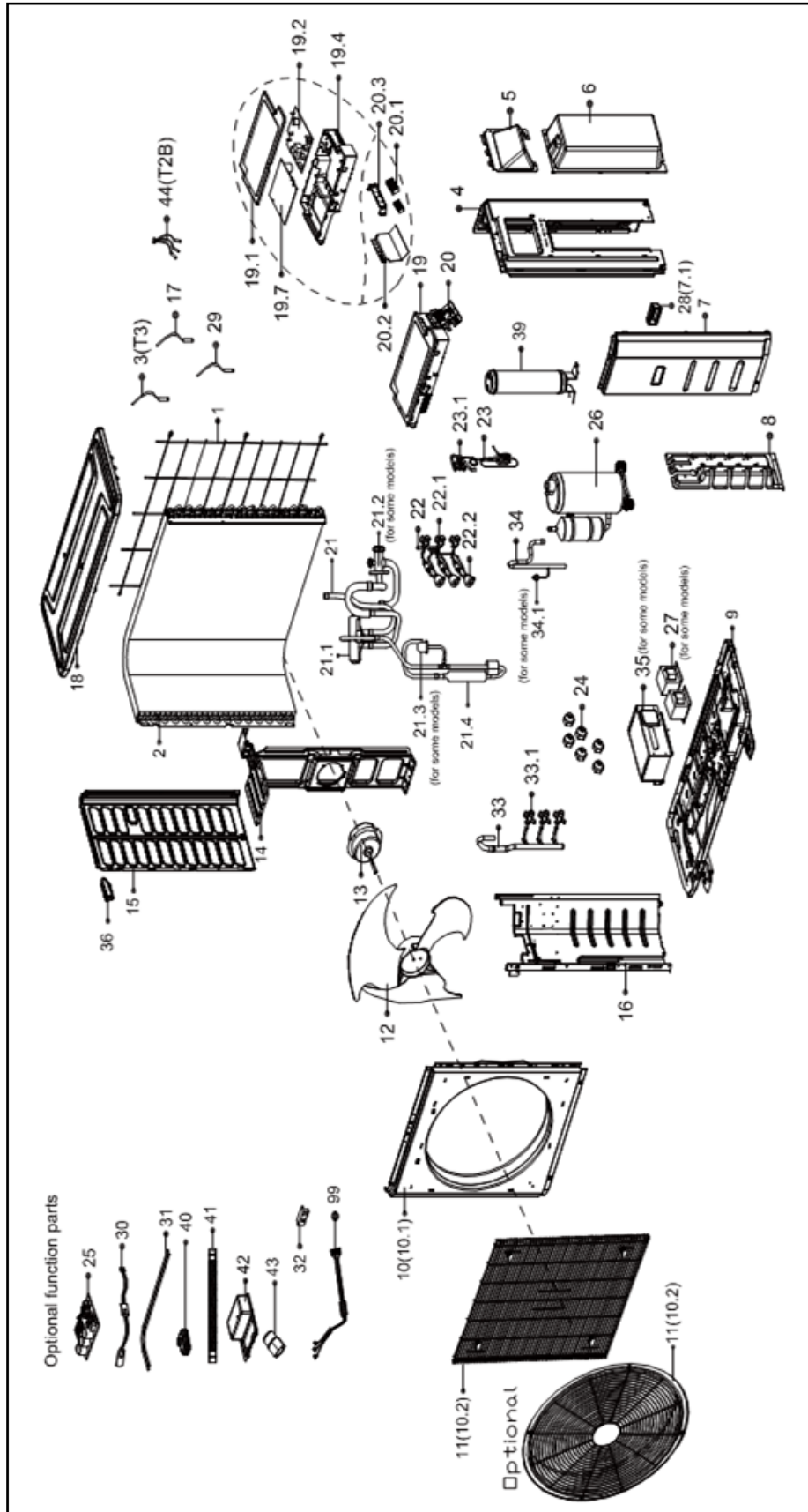

# REPLACEMENT PARTS

Location	Part Name	Quantity	Part No.
1	Rear net	1	12222000006604
2	Condenser assembly	1	15822000009578
3	Pipe Temperature Sensor	1	11201007003442
4	Rear right clapboard assembly	1	12222000012226
5	Big handle assembly	1	12222000011085
6	Water collector	1	12122300000110
7	Front right clapboard assembly	1	12222500A00135
7.1	handle	1	12100702000038
8	Valve plate	1	12222000005282
9	Chassis assembly	1	12222000005267
10	Front panel	1	12222000A01431
10.1	Front panel	1	12222000016109
11	Air outlet grille	1	12222000014845
12	Axial flow fan	1	12100105000084
13	Brushless DC Motor	1	11002015000247
14	Supporter subassembly of fan motor	1	12222500000547
15	Left side plate assembly of cabinet	1	12222000006665
15.1	Small handle	1	12100701000033
16	Partition board assembly	1	12222200001156
17	Room Temperature Sensor	1	11201007003448
18	Top cover assembly	1	12222500000587
19	Electronic control box subassembly	1	17222300002649
19.1	Cover of electronic control box	1	12122000006905
19.2	Main control board subassembly	1	17122300003977
19.4	Electronic installing box	1	12122300000170
19.7	Inverter module subassembly	1	17122000052007
20	Terminal board subassembly	1	17222300000729
20.1	Terminal	2	17400401000135
20.2	Terminal board	1	12222300000033
20.3	Terminal board	1	12222300000032
21	4-way Valve Assembly	1	15422000019432
21.1	4-way valve	1	15500216000361
21.2	Gas valve	1	15500204000049
21.3	Pressure switch	1	17400516000851
21.4	Muffler subassembly	1	15122000027837
22	Liquid valve assembly	1	15422300000404
22.1	Liquid valve	3	15500208000028
22.2	Electronic expansion valve subassembly	3	15500213000046
23	Liquid valve assembly	1	15422000016293
23.1	Liquid valve	1	15500208000047
24	Copper nut	3	15500406000016
24	Copper nut	2	15500406000010
24	Copper nut	3	15500406000012
26	DC Inverter Rotary Compressor	1	11103020000719
27	Reactor	1	17400306000058
29	Discharge Temperature Sensor	1	11201007003124
30	Electric heating tube	1	17402002000466
31	Crankcase electric heater	1	17402001000601
33	Gas valve assembly	1	15422000A01486
33.1	Gas valve	1	15500204000058
33.1	Gas valve	2	15500204000021
34	Suction pipe assembly	1	15122300001024
34.1	Pressure switch	1	17400516000848
39	Accumulator cylinder	1	15500508000315
41	Drain pipe	1	12100509000059
44	Pipe Temperature Sensor	1	11201007000044
99	Compressor wire subassembly	1	174012030000939

---

Due to ongoing product improvements, specifications and dimensions are subject to change and correction without notice or incurring obligations. Determining the application and suitability for use of any product is the responsibility of the installer. Additionally, the installer is responsible for verifying dimensional data on the actual product prior to beginning any installation preparations.

Incentive and rebate programs have precise requirements as to product performance and certification. All products meet applicable regulations in effect on date of manufacture; however, certifications are not necessarily granted for the life of a product. Therefore, it is the responsibility of the applicant to determine whether a specific model qualifies for these incentive/rebate programs.



1900 Wellworth Ave., Jackson, MI 49203 • Ph. 517-787-2100 • [www.marsdelivers.com](http://www.marsdelivers.com)

